

Office Space For Lease

2209 Elm & 1609 Broadway

Broadway Commercial Center Bellingham, WA



Contact

Greg Martineau
360-676-4866
greg@saratogacom.com

Hannah Cano
360-676-4866
hannah@saratogacom.com



- 1,012 - 4,000 sf & 182 - 204 sf*
- \$9-\$12/sf/yr + NNN
- Single Offices* available for \$15/sf/yr + NNN
- Close to Downtown
- Ample Parking
- ADA accessible
- Flexible floor plan configurations

Location:

Located close to downtown Bellingham in the Fountain District. Broadway Commercial Center is less than 2 miles from I-5

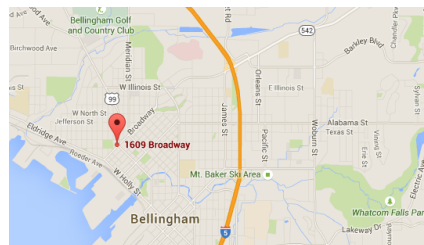

Saratoga
commercial real estate

First Floor



Second Floor

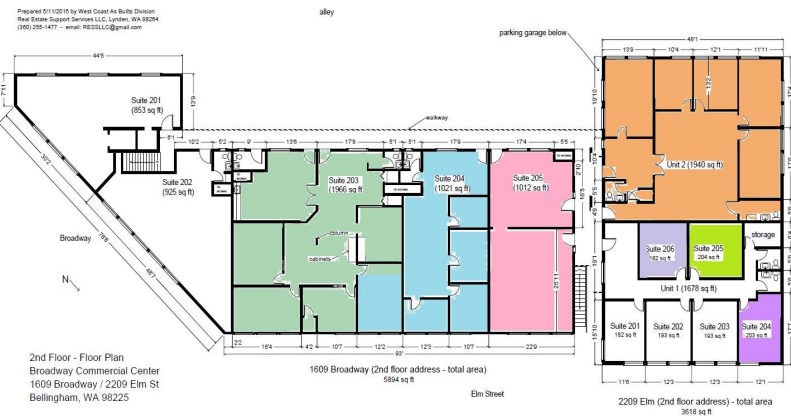

Property Fact Sheet	
Address:	2209 Elm & 1609 Broadway
Zoning:	Urban Village
Building:	2-story office building
Parking:	Shared and In Common
Elevator:	Yes

Contact

Greg Martineau
360-676-4866
greg@saratogacom.com

Amia Froese
360-676-4866
amia@saratogacom.com