

FOR LEASE

Haskell Business Center

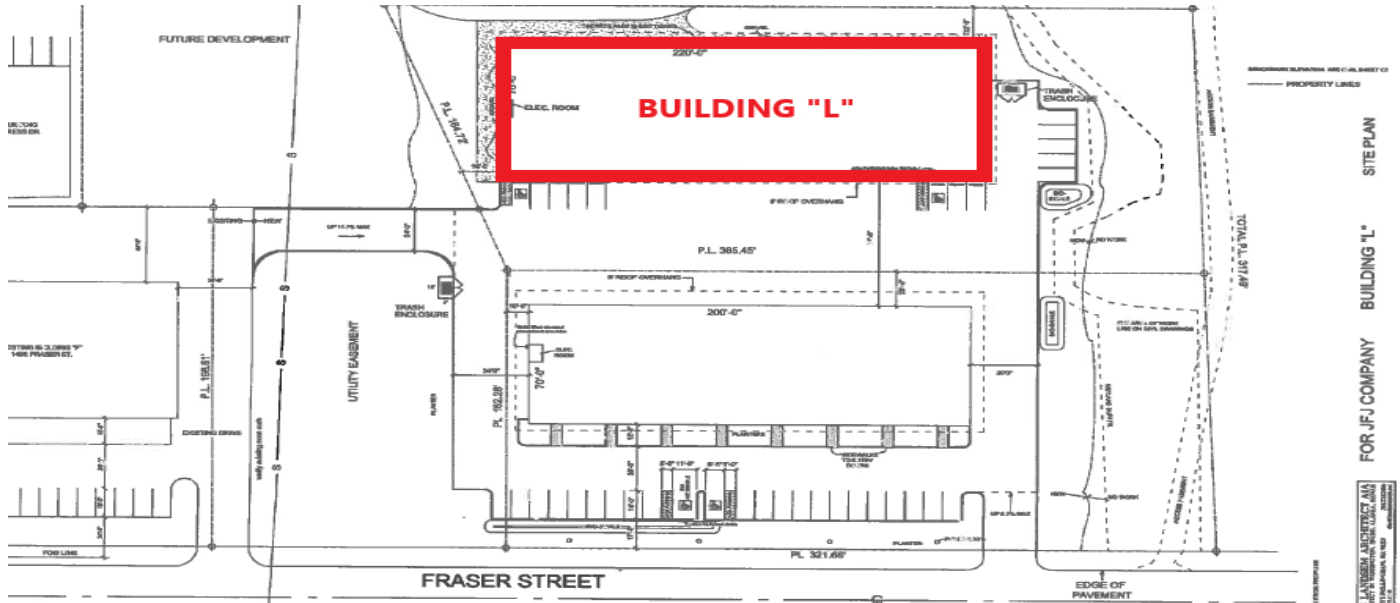

NEW CONSTRUCTION

1515 Fraser St., Bellingham, WA

Suite 1/8: 3,344 SF Total (748 SF Office)

\$0.80/sf/mo + NNN

Suites 2-7: 1,672 SF Warehouse ONLY

\$0.66/sf/mo + NNN

Available Fall 2019

Less than 1mi to I-5

3 Phase, 208V Power

16'-22' Warehouse Ceilings



Contact

Amia Froese, CCIM
360.676.4866
amia@saratogacom.com

NEW CONSTRUCTION

PROPERTY FACT SHEET

Address:	1515 Fraser Street Bellingham, WA
Site:	1.23 Acres
Zoning:	Light Industrial
Building:	Wood Frame
Year Built:	2019
Building Size:	16,720 SF
NNN:	\$0.15/sf/mo
Doors:	Grade Level
Parking:	Onsite
Ceiling Height:	16' - 22'
Electrical Service:	3 phase, 208V Power
Sprinkler System:	No

Contact

Amia Froese, CCIM
360.676.4866
amia@saratogacom.com

